

Information pack for examination candidates St Paul's Hall, University of Huddersfield



This Information Pack contains the following material:

- § General pistons: information on use
- § Information including specification, accessories, and Level 1 divisional piston settings (This document is taken with permission from the website of the Huddersfield Organists' Association at <http://www.hudds.org.uk> [under 'Organ Archive/St Paul's Hall']. Candidates are specifically referred to the section 'RCO Candidates', and are encouraged to view this document online in order to benefit from the detailed photography.)
- § Diagrammatic representation of toe piston layout
- § Map of the venue.

IMPORTANT

Under no circumstances should candidates contact the examination centre directly. Please address all enquiries, in the first instance, to Andrew Macintosh at the RCO (telephone 020 3865 7004; email andrew.macintosh@rco.org.uk)

GENERAL PISTONS: INFORMATION ON USE

Candidates are invited to set General Pistons (up to a maximum of six) using only the channel allocated to them. There is no obligation to use General Pistons.

All candidates may use divisional pistons (channel 1 only)

Your allocated General Piston Channel is given in the covering letter that accompanies this Information Pack.

Candidates wishing to use General Pistons are requested to record their settings at the practice session and to keep this information for use at the examination. Time will be allowed at the beginning of the examination to prepare and/or check the settings.

If you use general pistons make sure that you have set your allocated channel.

Candidates are reminded that the sequencer is not available for the examinations. All sequencer 'plus' and 'minus' pistons will not operate.

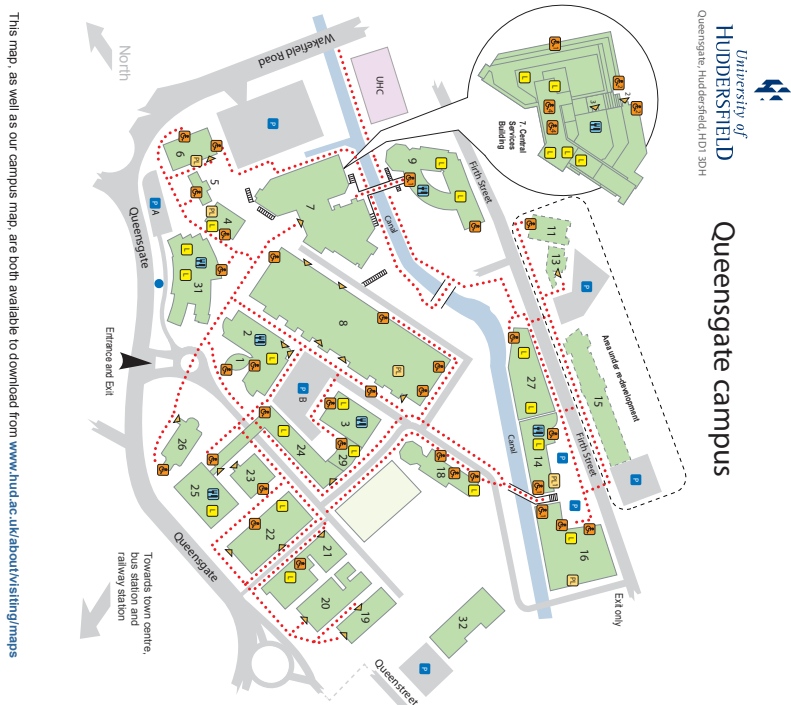

University of
Huddersfield
Queensgate, Huddersfield, HD1 3DH

Queensgate campus

Building Index	
Burwick Avenue	6a
Burwick Building (B)	5
Business School (BS)	9
Canalide East (CE)	14
Canalide West (CW)	16
Central Services Building (CS)	7
Creative Arts Building (CA)	31
Estates Building (EB)	20
Harold Wilson Building (HW)	2
Human & Health Research Building (HH/R)	18
Humanism & Media Building (HM)	29
Enterprise and Innovation Centre (under construction)	15
Lockside Building (LS)	27
Milton Building (MB)	21
Painting Services	20
Queen St. South Avenue (QSA)	19
Queensgate Studios	32
Ramsden Building (R)	22
Ramsden Workshops (RW)	23
Science Building (X)	25
Shoreward Building (S)	4
Sports Hall (SH)	6
Students' Union (SU)	3
St Pauls Hall	26
Technology Building (T)	8
The Buckley Lecture Theatre (CSL)	18
University Reception	1
West Building (W)	24
Visitor Car Parks (first management only)	
QAS Car Park	A
Central Car Park	B

School Offices Index	
Applied Sciences	24
Art, Design and Architecture	31
Art	31
Design	31
Architecture and 3D Design	14
Business	9
Computing & Engineering	16
Education & Professional Development	27
Human & Health Sciences	2
Music, Humanities & Media	31
Music	31
Humanities & Media	24

Key Services Index	
Business Mates	7
Consulting Service	19
Estates and Facilities	20
External Builders Group	7
Faith Centre	19
Financial Services	18
Health and Safety	7
Human Resources Group	18
Information Skills Centre	5
Planning & Information Services	7
Registry	7
Student Centre	7
Student Admissions and Records	7
Computing & Library Services	7
Student Finance	7
Student Services	7
Students' Union	3
University Health Centre	3

Key	
Entrance	Accessability Entrance
Passenger Lift	Accessability Lift
Catering Facilities	Accessability Rule
Car Park	Accessability Rule
Bus Stop for Students' Hall Campus	Accessability Rule

NOTE: Arrows mark a signal device at the entrance to a building. Example: Accessability entrance on level 1

Version 1.10 (colour) - Last revised 25-08-2011

This map, as well as our campus map, are both available to download from www.hudd.ac.uk/about/visiting/maps

Practical examinations take place in St Paul's Hall (26).

Written Papers take place in the Harold Wilson Building (2).

On the day of the examination, rooms and buildings will be signposted clearly.

On the day of your booked practice time, please report to Security at the main gate.

Builder Wood of Huddersfield (1978, 1991 and 1997)
Designers Philip Wood, Keith Jarvis (Tonal); David Graebe (Casework)
Compass Manuals: C1 to C61, Pedals C1 to F30
Action Mechanical key, pedals, coupling. Electric stop action.
Blowing Fan/blower reservoir/turbulence attenuator/schwimmers.

Manual III (enclosed) - wind pressure 63mm

1 Tremulant
 2 Trompette 8
 3 Basson Hautbois 16
 4 Mixture 4 ranks 2
 5 Tierce 1 2/3
 6 Waldflöte 2
 7 Nazard 2 2/3
 8 Koppelflöte 4
 9 Principal 4
 10 Holz Gedackt 8
 11 Spitzgamba 8
 12 Célèste 8 TC

Pedal - wind pressure 60mm

13 Tremulant
 14 Schalmey 4
 15 Trompette 8
 16 Posaune 16
 17 Contra Posaune 32
 18 Mixture 6 ranks 2 2/3
 19 Nachthorn 2
 20 Octave 4
 21 Rohr Gedackt 8
 22 Octave 8
 23 Principal 16
 24 Sub Bass 16
 25 III - Pedal
 26 II - Pedal
 27 I - Pedal

Manual I - wind pressure 53mm

28 Cromorne 8
 29 Scharf 4 ranks 1 1/3
 30 Octave 1
 31 Sesquialtera 2 ranks 2 2/3
 32 Quinte 1 1/3
 33 Blockflöte 2
 34 Principal 2
 35 Rohrflöte 4
 36 Praestant 4
 37 Gedackt 8

* Tremulant
 38 III - I
 39 Cymbelstern

Manual II - wind pressure 60mm

40 Cornet 4 ranks 4 C13 - G56
 41 Trompette 8
 42 Trompette 16
 43 Scharf: 4 ranks 1
 44 Mixture: 5-6 ranks 2
 45 Gemshorn 2
 46 Spitzflöte 4
 47 Octave 4
 48 Rohrflöte 8
 49 Principal 8
 50 Gedacktpommer 16

* Tremulant
 51 III - II
 52 I - II

Piston Couplers.

[these stops are not settable on pistons, and are not on the Gen. Cancel]

53 II and Pedal pistons combined
 55 I on Pedal pistons
 54 III on Pedal pistons.

53 couples division pistons on Man. II to Ped. divisional pistons and vice-versa.

55 places Man I divisionals onto Ped general pistons.

54 places Man III divisionals onto Ped general pistons.

54/55, when drawn, remove the general piston settings from the Ped. generals. The general settings are still available on the Manual general pistons.

* refers to unnumbered stops on the console. These stops can be set on pistons.

Pistons reading from bass to treble

1. under Man I keyslip:

: Setter : : - : : I-P : : DIV 1 : 2 : 3 : 4 : 5 : 6 : 7 : 8 : : + : : 111-1 : : Gen Cancel :

2. under Man II keyslip:

GENS 1 : 2 : 3 : 4 : : + : : II-P : : DIV 1 : 2 : 3 : 4 : 5 : 6 : 7 : 8 : : + : : III-II : : III-II :

3. under Man III keyslip:

GENS 5 : 6 : 7 : 8 : : + : : III-P : : DIV 1 : 2 : 3 : 4 : 5 : 6 : 7 : 8 : : + : : Seq Restore :

4. Ped Bass Toeboard:

Top : III-I : : I-II : : III-II : : + : : [Sw.Ped]
 Bottom : GEN8 : 7 : 6 : 5 : 4 : 3 : 2 : 1 : : [Sw.Ped]

5. Ped Treble Toeboard:

Top [Sw.Ped] : + : : II-Ped : : III-Ped : : I-Ped : : Cymbelstern :
 Bottom [Sw.Ped] DIV 1 : 2 : 3 : 4 : 5 : 6 : 7 : 8 :

Piston Settings

Pistons are set in the normal way by means of the setter piston.

A standard setting is provided on Level 1 divisional and general pistons.

There is a total of 8 levels of memory for divisional pistons and 96 levels for generals.

Standard piston settings Level 1 Divisional pistons. [Principal stops in bold, reeds placed at end of list.]

Manual I

Div.1 8.
 Div.2 8.4.
 Div.3 8.4.
 Div.4 8.4.2.
 Div.5 8.4.2.1.
 Div.6 8.4.2.1.IV
 Div.7 8.4.2.1 1/3.11.
 Div.8 8.8.

Manual III

Div.1 8.8TC.
 Div.2 8.8.
 Div.3 8.4.
 Div.4 8.4.
 Div.5 8.8.4.2.
 Div.6 8.8.4.2.IV.
 Div.7 8.8.4.IV.8.
 Div.8 8.8.4.IV.16.8.

Manual II

Div.1 8.
 Div.2 8.4.
 Div.3 8.8.4.
 Div.4 8.8.4.
 Div.5 8.8.4.2.
 Div.6 8.8.4.vi
 Div.7 8.8.4.vi.IV.
 Div.8 8.8.4.vi.IV.8.

Pedal

Div.1 16.
 Div.2 16.8.
 Div.3 16.16.8.
 Div.4 16.16.8.8.
 Div.5 16.16.8.8.4.
 Div.6 16.16.8.8.4.vi.
 Div.7 16.16.8.8.4.vi.16.
 Div.8 16.16.8.8.4.vi.16.8.

Divisional and General Pistons - Selection of Memory Level

Use the up/down buttons below displays[at bottom of Pedal stop jamb]

The locking system for the General pistons is underneath the music desk, along with the speed and depth controls for the Tremulants.